

Broadway Complete Streets Project



Broadway Complete Streets Project





Broadway Complete Street Project

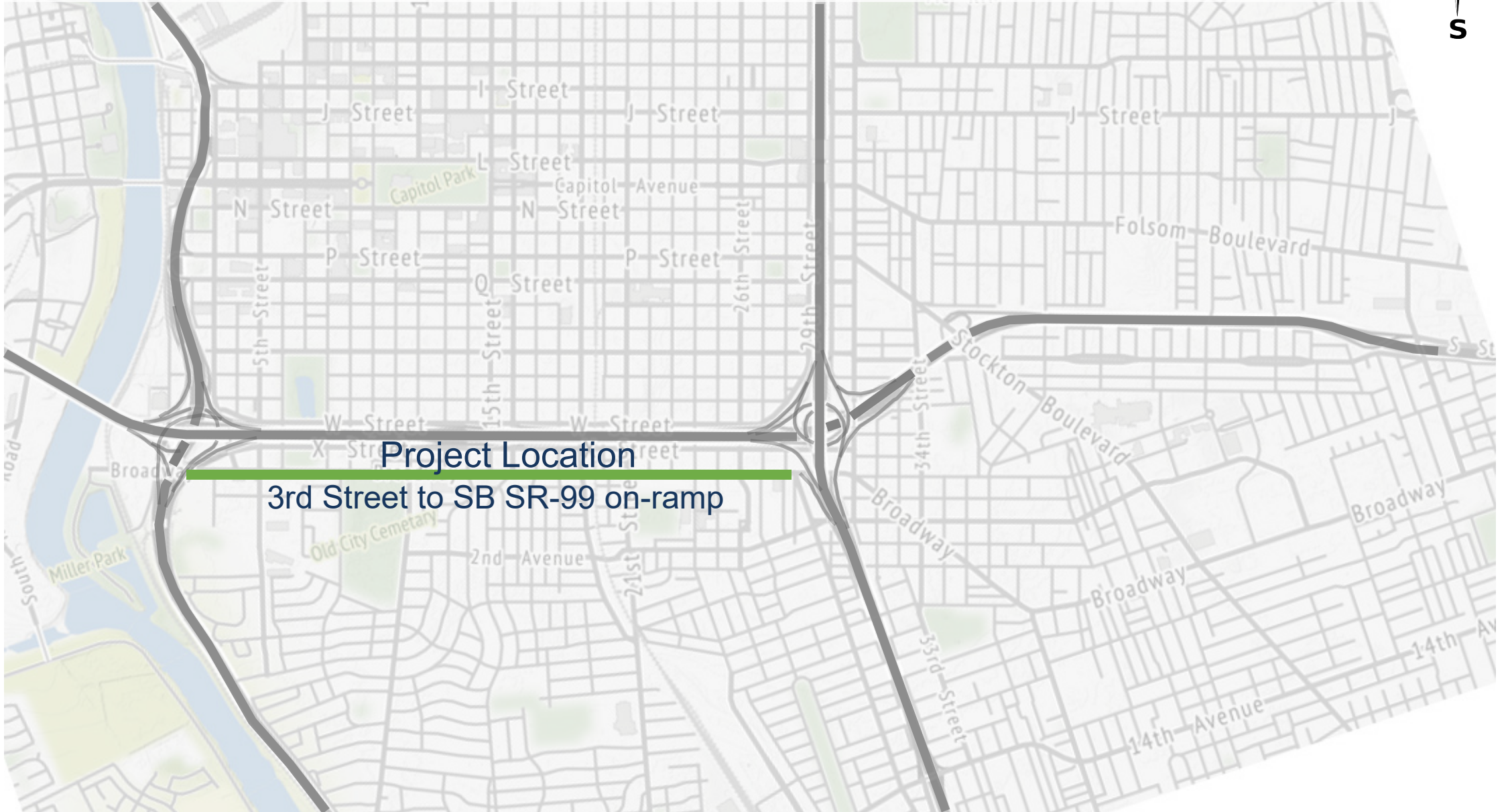
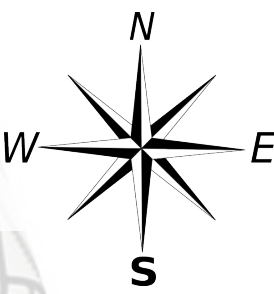



Broadway Complete Street

Existing Conditions

- 4 travel lanes
- On-street parking
- Painted median (sometimes)
- No bicycle lanes
- Between 13,000 – 19,000 cars/day

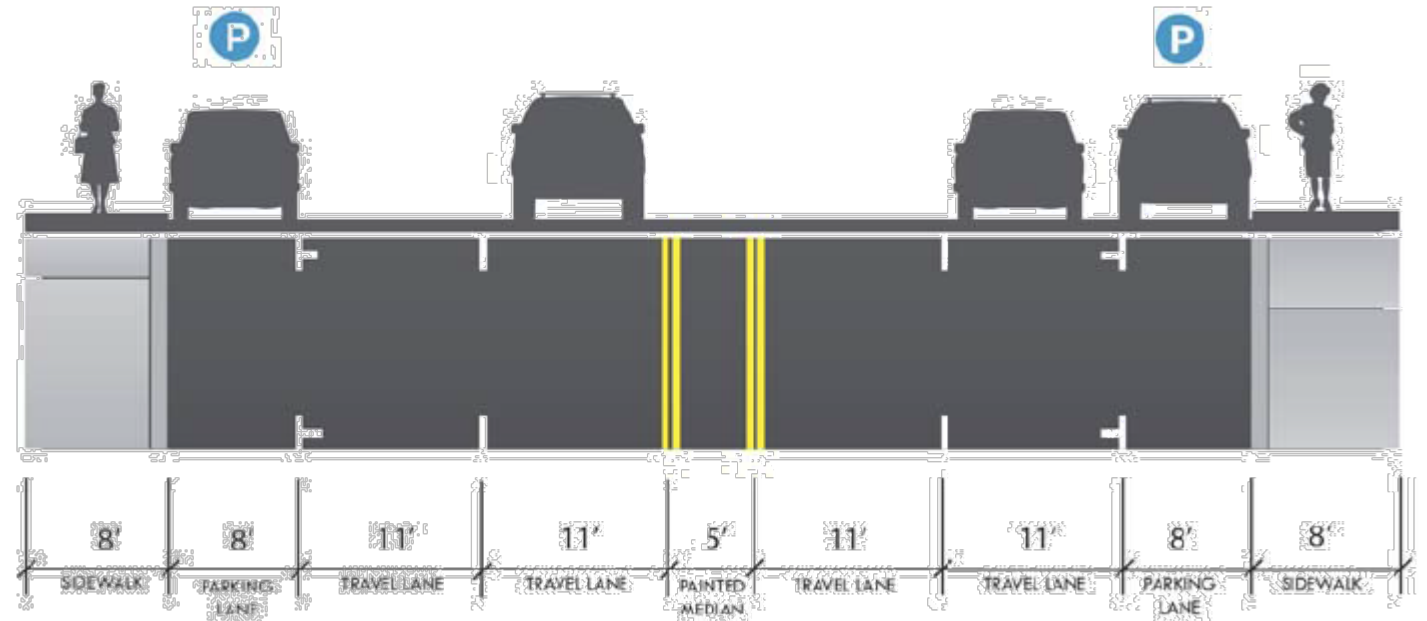



Broadway Complete Street Project

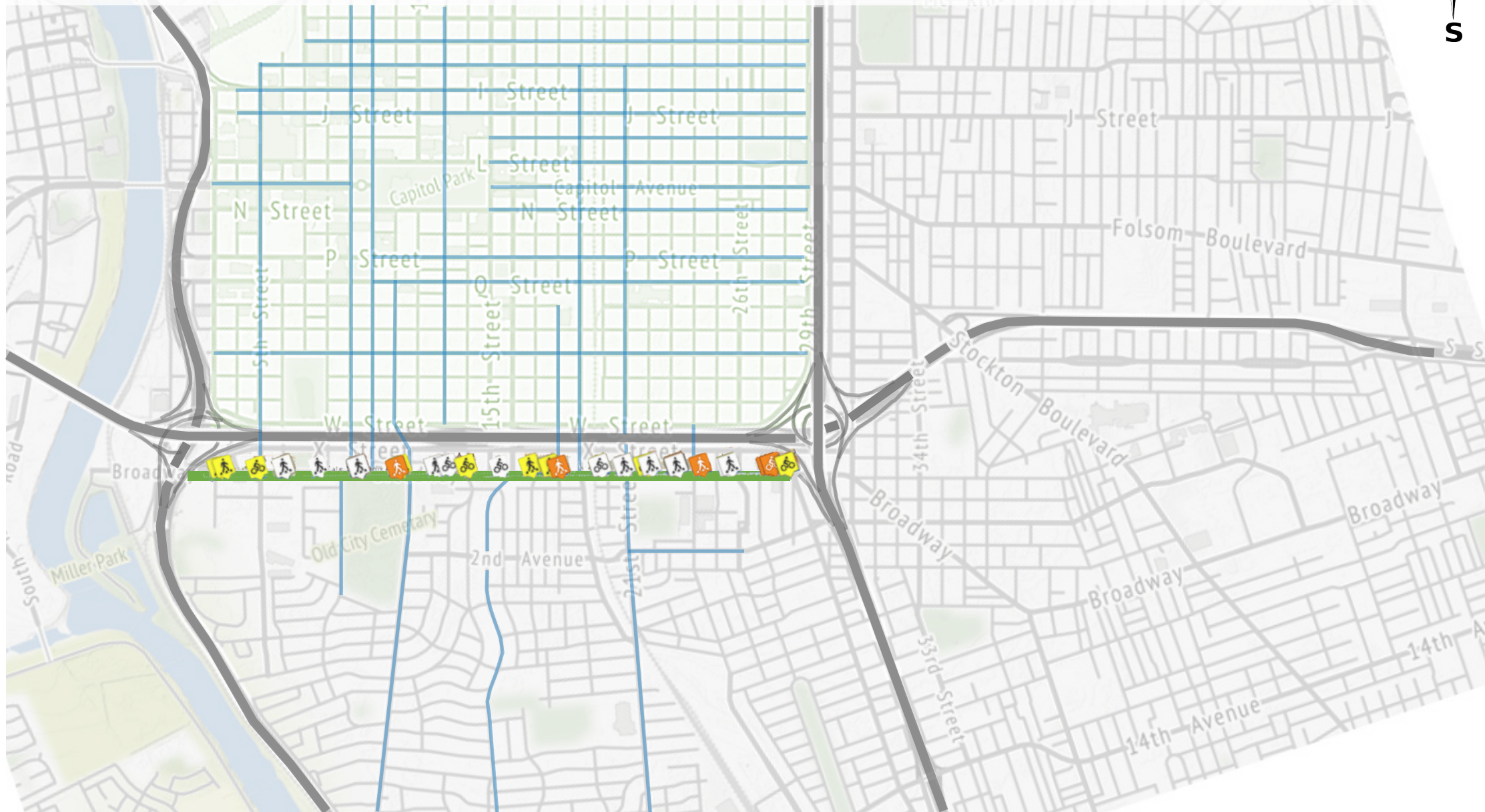
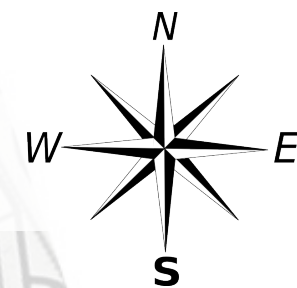



Broadway Complete Street

Project Goals established through Plans

- Balance accessibility for bicyclists, pedestrians, transit users, and drivers
- Enhance safety and comfort for all modes of travel, especially vulnerable pedestrians and bicyclists
- Improve connectivity between:
 - the residents south of Broadway
 - the businesses along Broadway
 - Downtown/Midtown
- Encourage economic revitalization and reinvestment along the Broadway corridor

Broadway at 18th



Tower Gateway





Broadway Complete Street

Proposed Improvements

The project proposes to include:

- Reduction from 4 to 2 lanes
- Consistent two-way left turn lane
- On-street parking where appropriate
- Buffered bike lanes



Existing

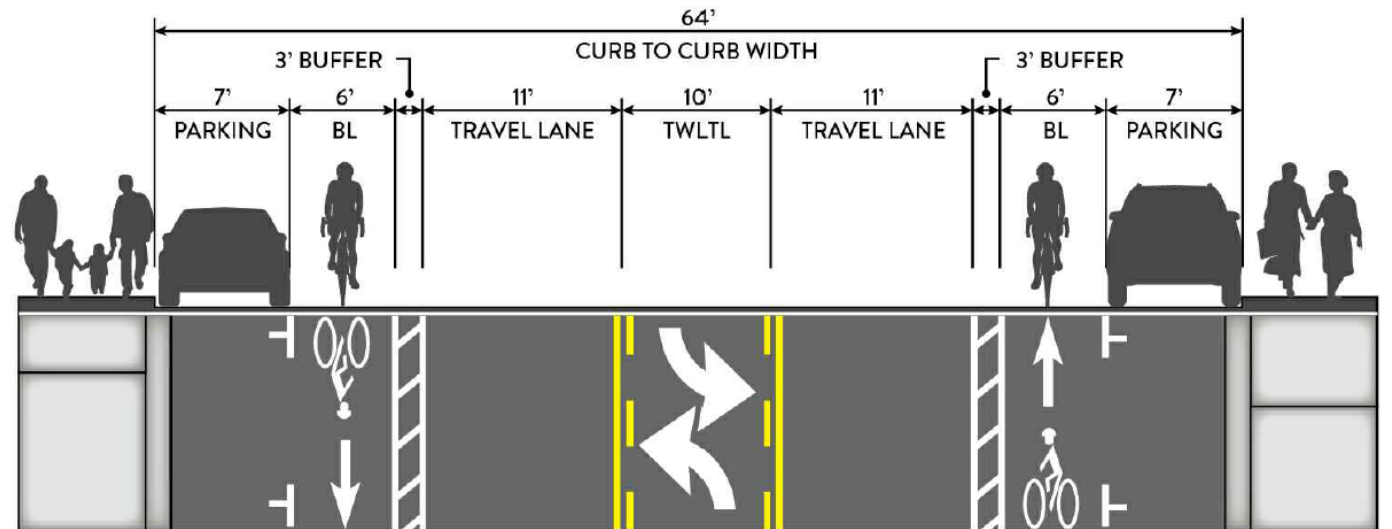

Proposed



Broadway Complete Street

Proposed Improvements

The project proposes to include:

- Reduction from 4 to 2 lanes
- Consistent two-way left turn lane
- On-street parking where appropriate
- Buffered bike lanes
- Replace rolled curb with vertical curb and sidewalk reconstruction as necessary.
- Pedestrian lighting, prioritized at uncontrolled crossings and transit stops
- Pavement rehabilitation

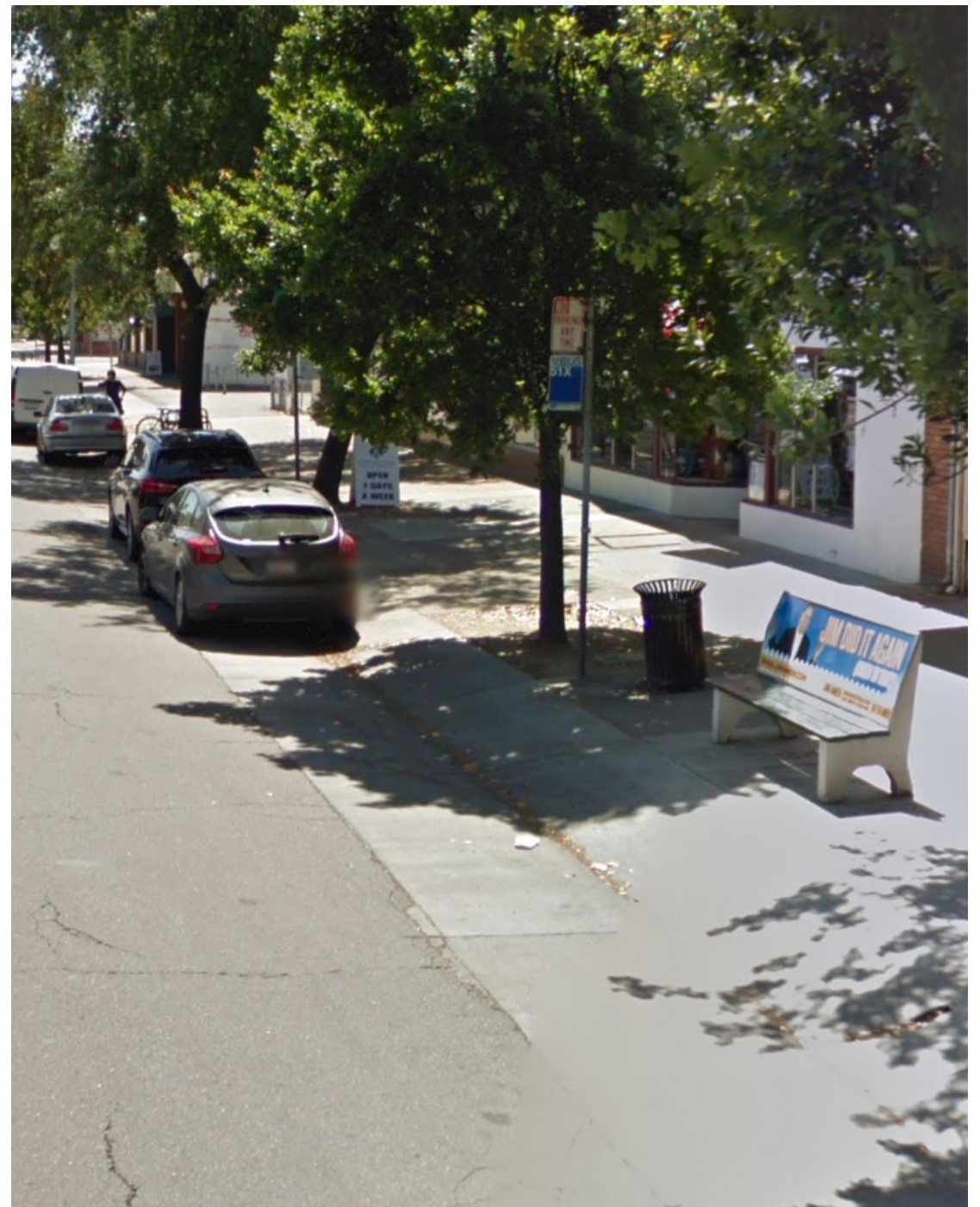



Broadway Complete Street

Proposed Improvements

Circulation Improvements:

- New roadway segment (29th Street) between Broadway and X Street
- Two-way conversion of 16th Street between Broadway and X Street

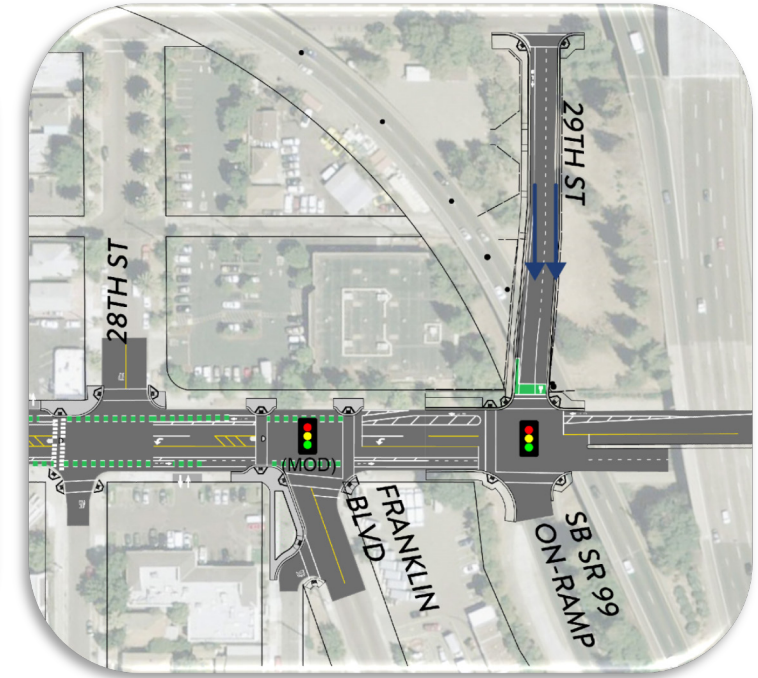
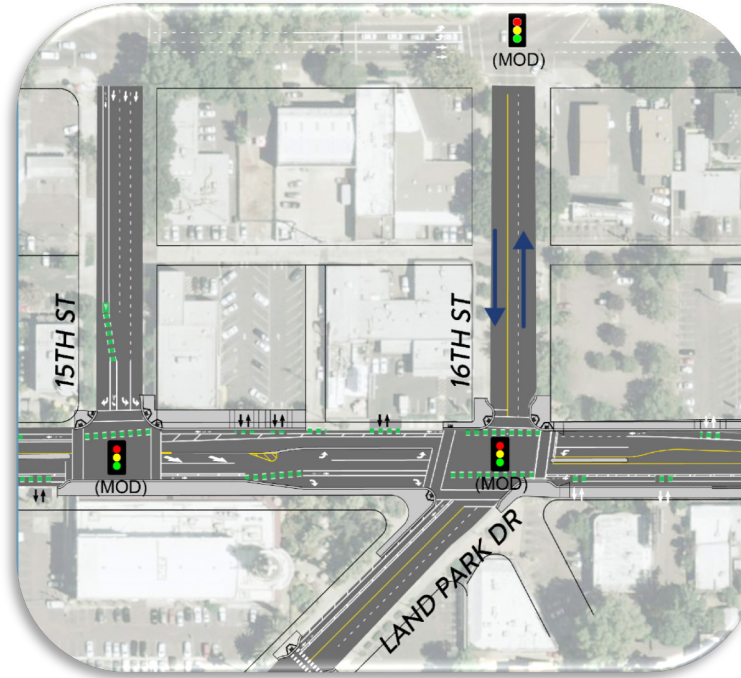



Broadway Complete Street

Traffic Operations

General trends in travel pattern changes:

- Average number of cars on Broadway will go from 16,000 to 12,000 per day.
- These commuter trips tend to shift to parallel facilities: X Street (1,300 cars/day), W Street (1,200 cars/day), or to the grid to access Business 80 or Highway 99.

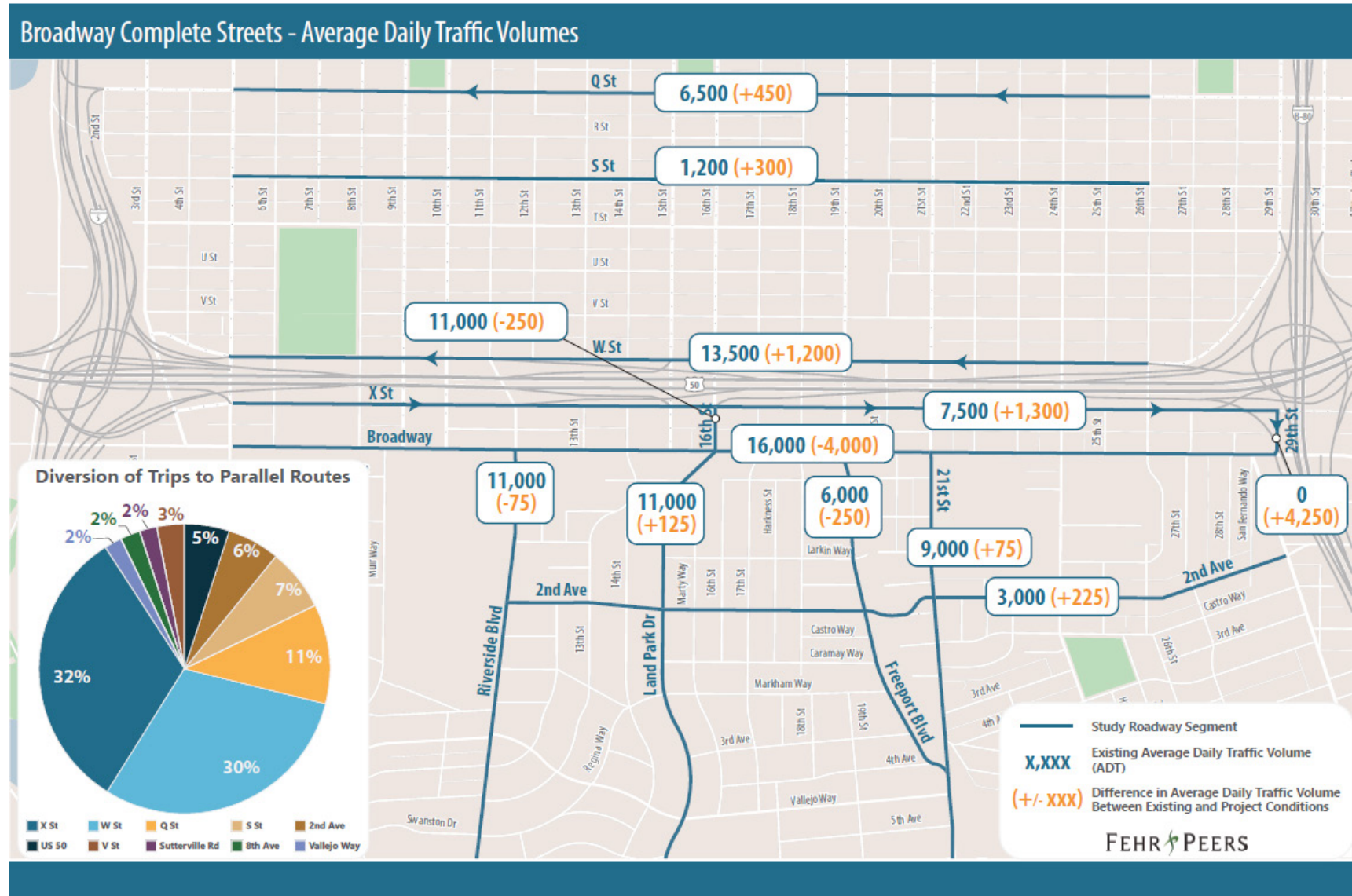



Broadway Complete Street

Pedestrian Crossings

Broadway is currently challenging to cross at unsignalized intersections





Broadway Complete Street

Proposed Improvements

Pedestrian Crossing Enhancements:

- Consistent with the current Pedestrian Crossing Guidelines
- Most intersections will have pedestrian crossing enhancements

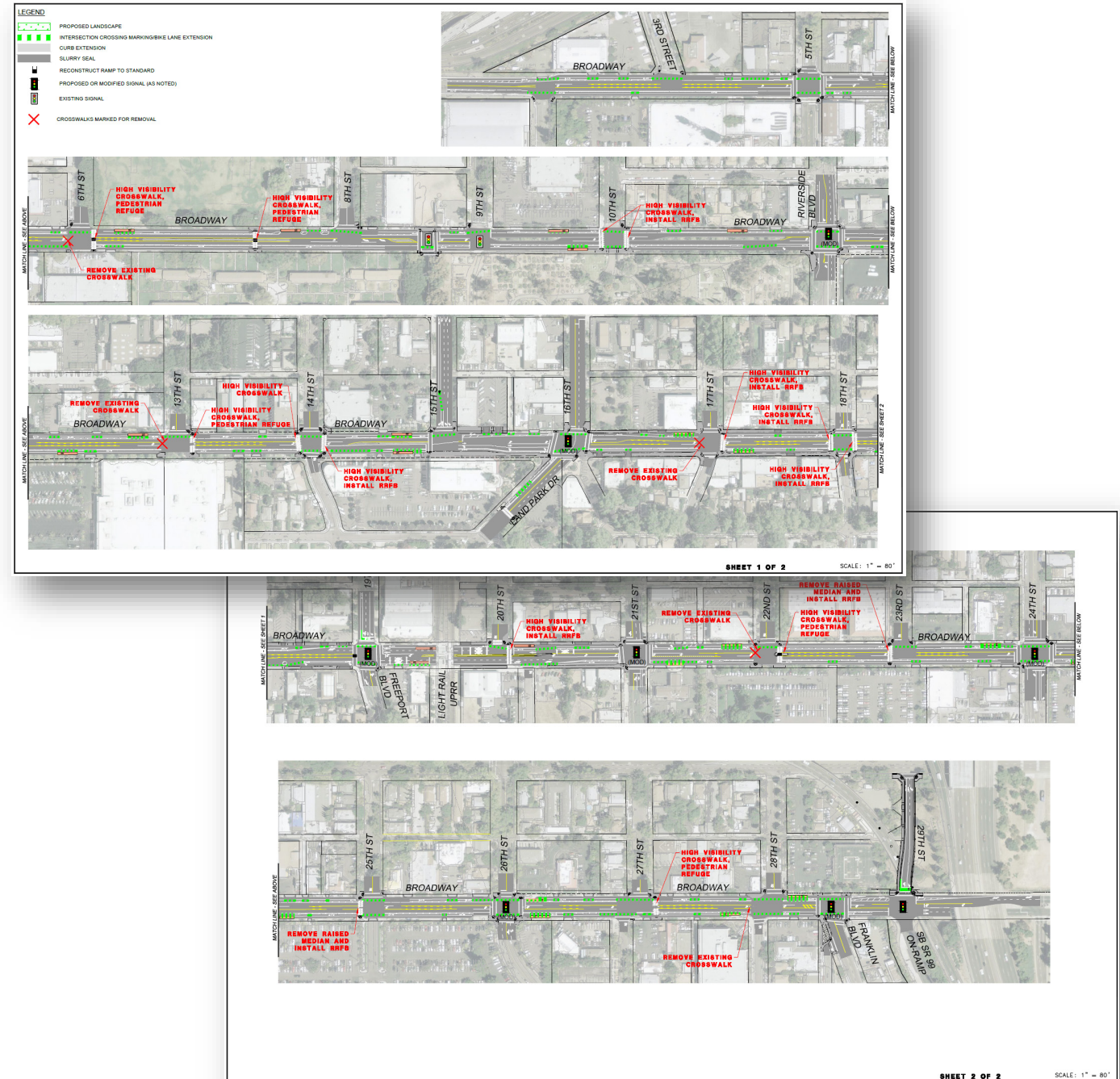



Broadway Complete Street

Proposed Improvements

Pedestrian Crossing Enhancements:

- Consistent with the current Pedestrian Crossing Guidelines
- Crosswalks will include High Visibility Markings and either:
 - Pedestrian Refuge Island or
 - Rectangular Rapid Flashing Beacon
- Bulb-outs (where feasible)

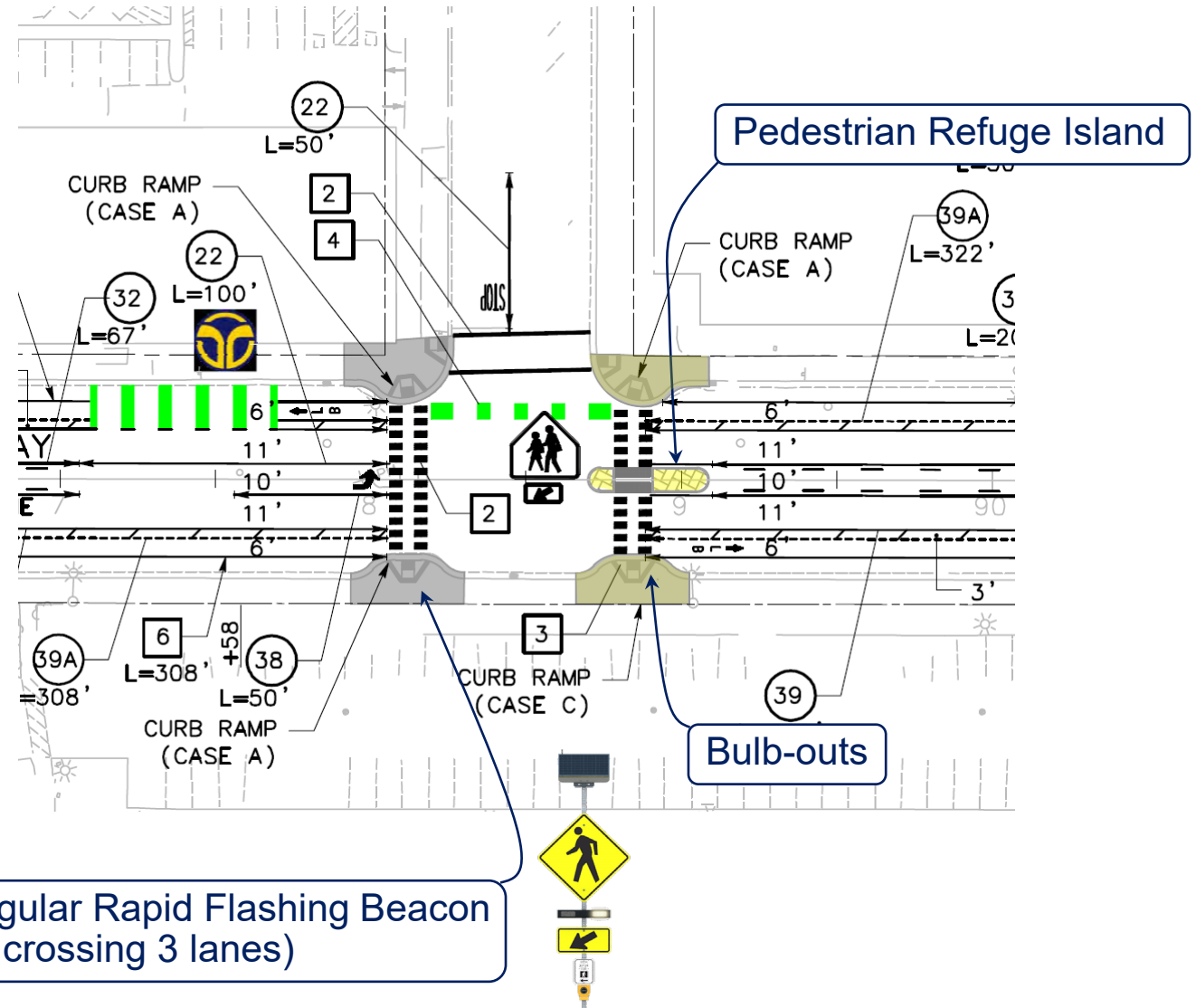



Broadway Complete Street

Proposed Improvements

Bus Stops

- Coordinating final locations with RT
- Changes in locations are due to:
 - Requests from RT to consolidate service points or improve efficiency
 - Changes in routing for bus line
 - Requirements from UPRR to move from vicinity of tracks

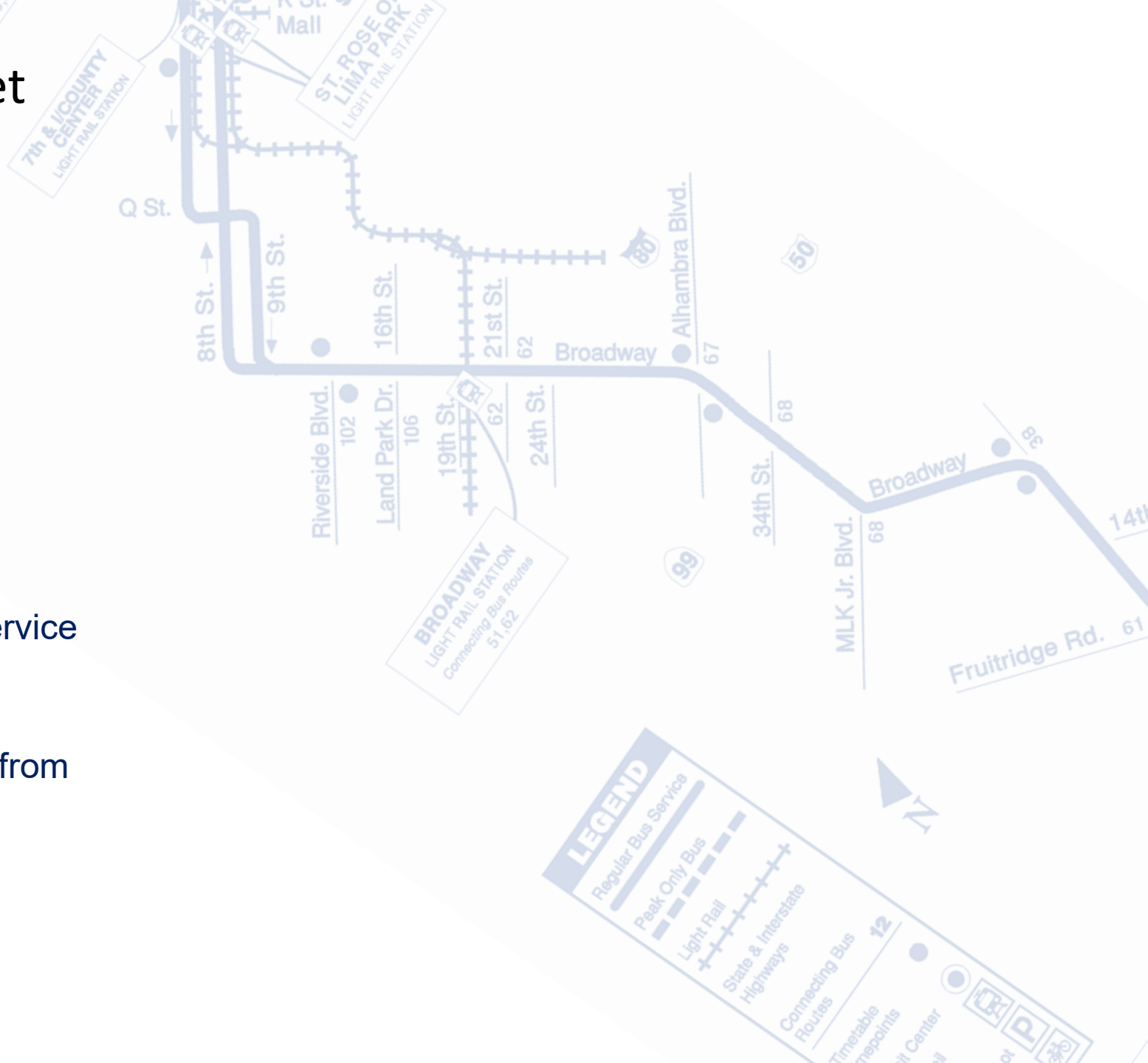



Broadway Complete Street

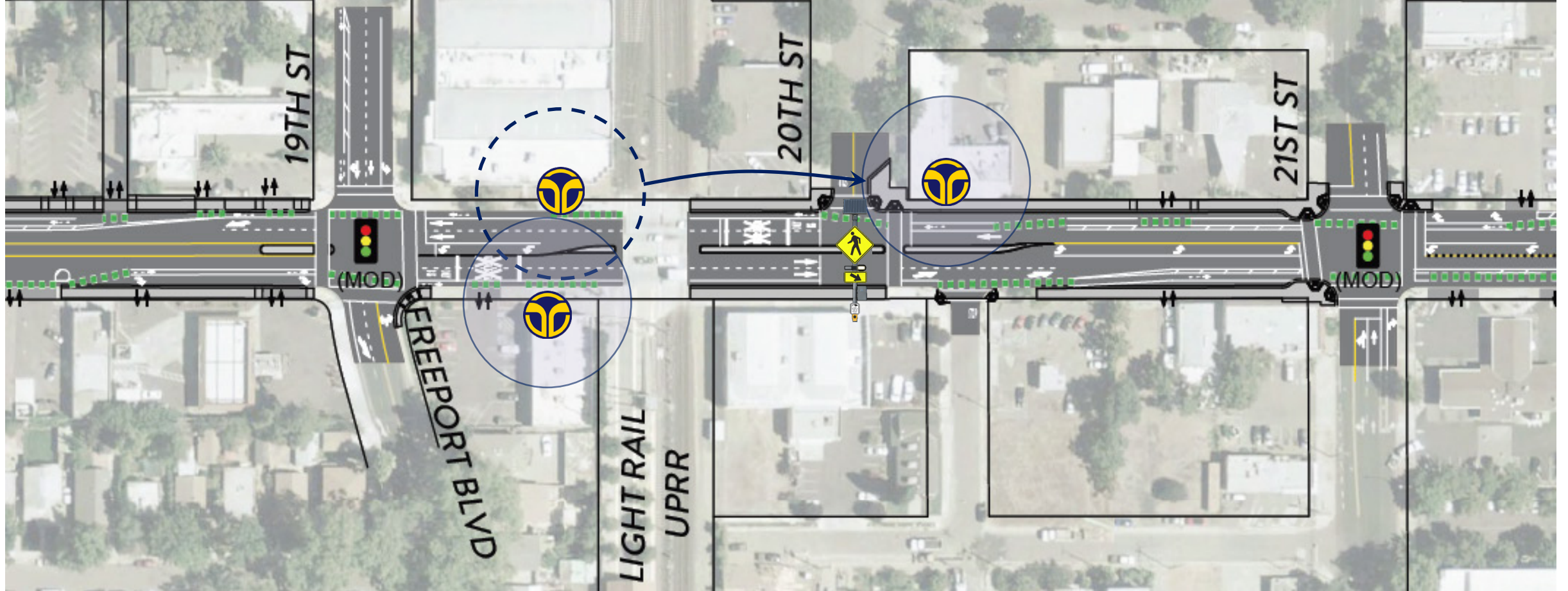



Broadway Complete Street

Process and Coordination

Union Pacific Railroad

- PE agreement with UPRR required
- Diagnostic meeting
- Maintenance Consent Letter (MCL)
- GO88-B permit from CPUC

Caltrans

- 29th Street extension is within Caltrans ROW
- Encroachment permit required, with a Permit Engineering Evaluation Report (PEER)
- Freeway agreement amendment will be required.
- An amendment to the existing maintenance agreement and electrical maintenance agreement will be required.

Transit

- Coordination with Regional Transit on bus stop locations
- Plan review from Regional Transit for roadway improvements at their light rail crossing



Other Projects

- Broadway Complete Street Project (early 2023)
- Central City (Downtown) Mobility Project (early 2023)
- DOU Transmission Water Main (2022 – early 2023)
- Development projects
- Caltrans projects
 - Clean CA beautification project

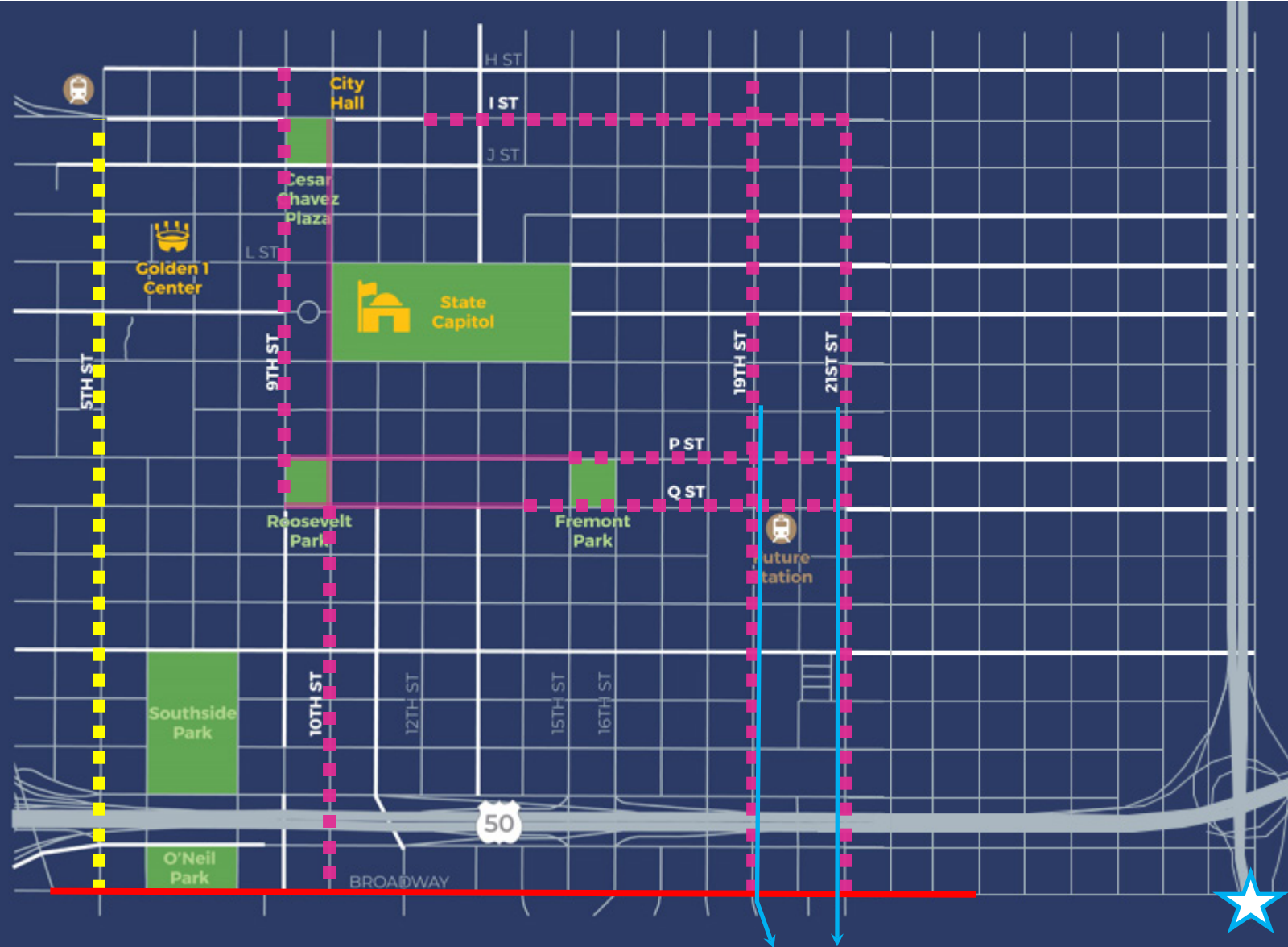



Broadway Complete Street

- The project was separated into segments for purpose of pursuing grants:
 - **Phase 1:** From 3rd Street to Land Park Drive / 16th Street, with 29th Street Extension
 - **Phase 2:** From Land Park Drive to 24th Street
- Both segments received Active Transportation Program funding
- These phases will be designed together and constructed as one package

Project Phasing





Broadway Complete Street

Project Phasing

- The project was separated into segments for purpose of pursuing grants:
 - **Phase 1:** From 3rd Street to Land Park Drive / 16th Street, with 29th Street Extension
 - **Phase 2:** From Land Park Drive to 24th Street
- Both segments received Active Transportation Program funding
- These phases will be designed together and constructed as one package





Broadway Complete Street

Project Funding

Phase 1&2

Total Construction & CM Costs	\$13,479,000
Active Transportation Program (Cycle 3)	\$2,410,000
Active Transportation Program (Cycle 4)	\$3,111,000
Local Match to ATP	\$1,826,000
SACOG Community Design Grant	\$3,000,000
SACOG Regional Program Grant	\$3,402,000

Phase 3

Design Costs	\$500,000
Construction & CM Costs	\$2,766,000
SACOG Regional Prog. Grant	\$3,266,000

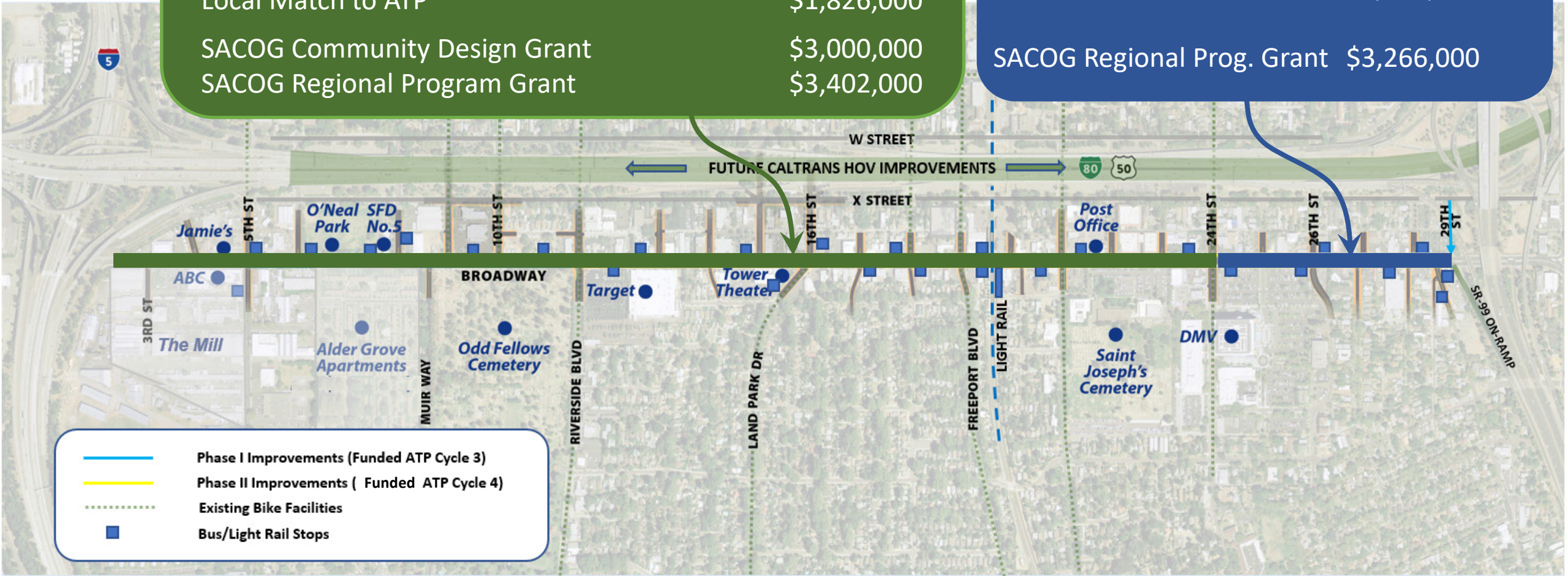

- Phase I Improvements (Funded ATP Cycle 3)
- Phase II Improvements (Funded ATP Cycle 4)
- - - Existing Bike Facilities
- Bus/Light Rail Stops



Broadway Complete Street

Project Timeline

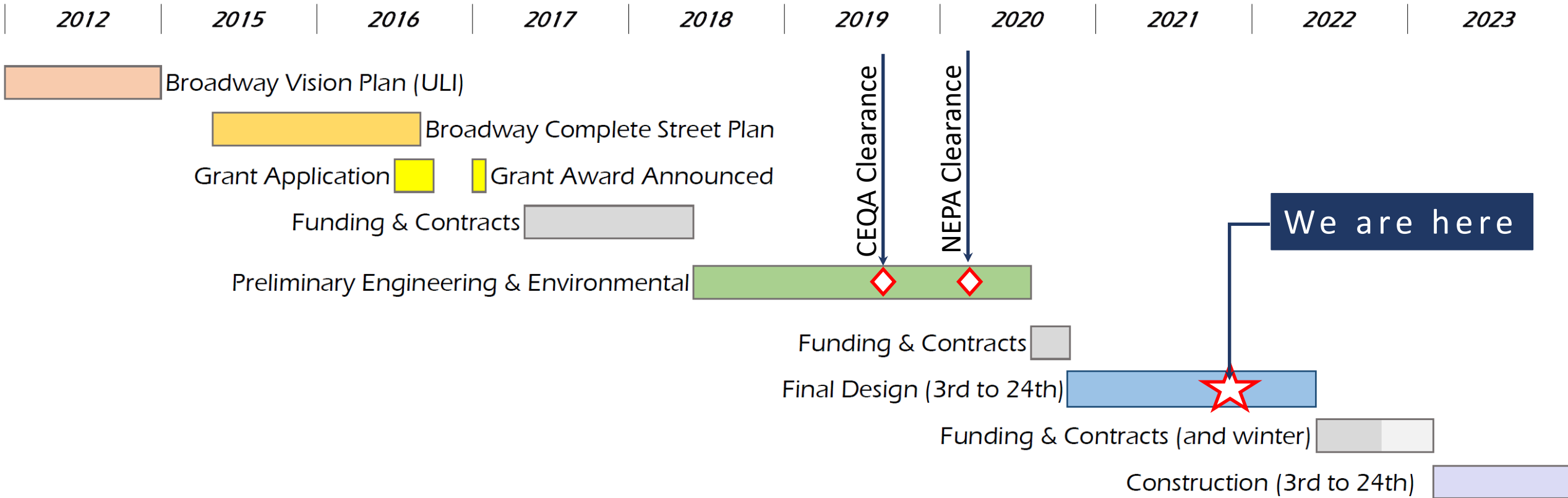



Broadway Complete Street

Next Steps

- 65% plans will be submitted early December
- This will have more updated and “engineered” design.
- Evaluate the 65% estimate against the budget; identify adjustments needed
- Coordination with businesses on sidewalks, parking, etc.

Anticipated Outreach/Engagement

- An outreach firm is on board to help message before and during construction.
- Messaging will target: businesses, residents, and transit riders
- Will work closely with the Greater Broadway Partnership to help communicate with businesses.